

Mounting instructions

Side bar series: GM - GC- BM - BC

Iveco Daily 2014+ **L2 / L3 (WB3520)** **L4 / L5 (WB4100)**



SW13 (23 Nm)



SW17 (46 Nm)



45 Min.

Version: May 2021



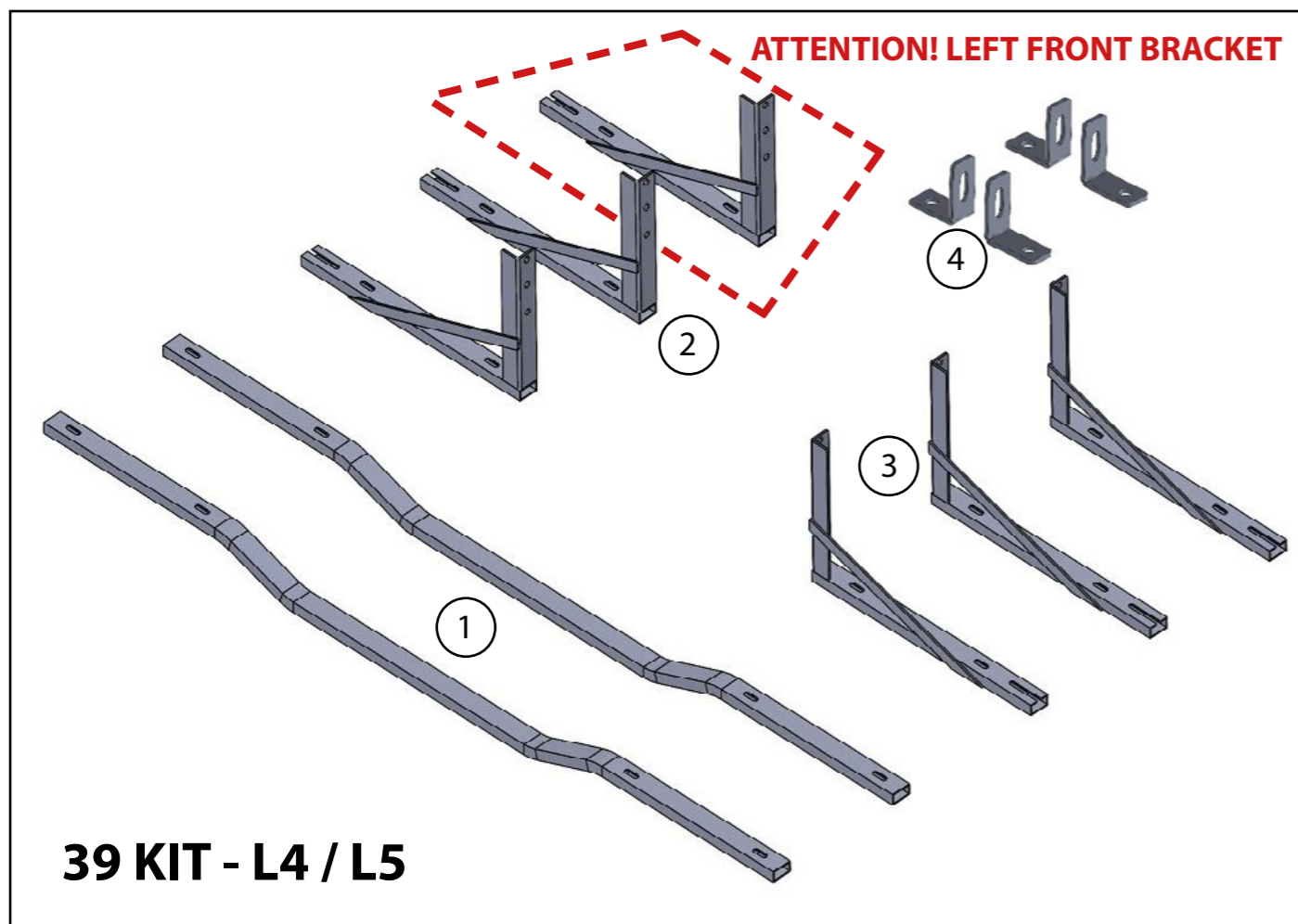
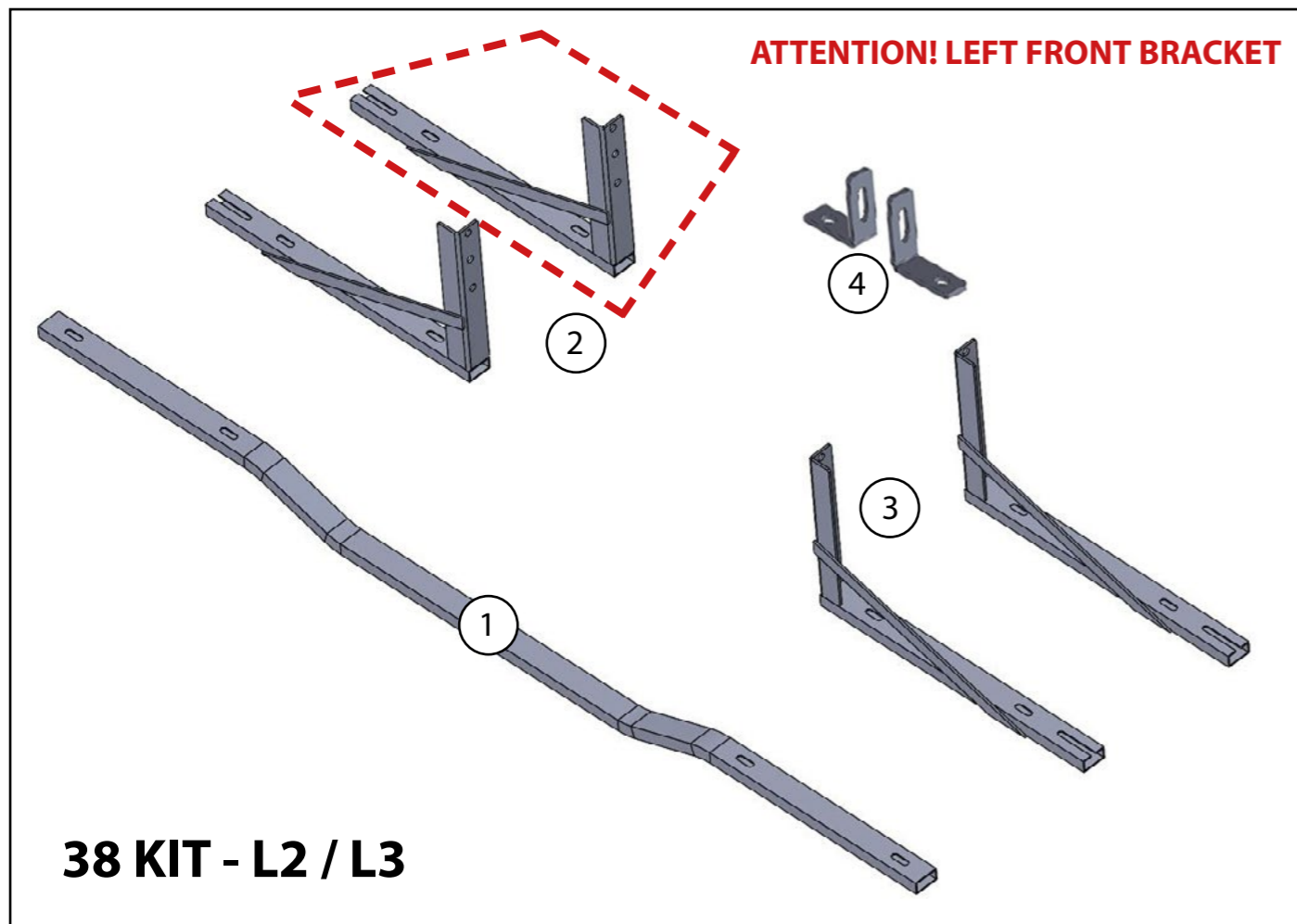

Part number	Part name	Quantity	Quantity
1	See 38KIT /39KIT Cross bar	1	2
2	See 38KIT /39KIT Right bracket	2	3
3	See 38KIT /39KIT Left bracket	2	3
4	See 38KIT /39KIT 90° bracket with sleeving hole	2	4
5	 M8x35 Bolt	6	10
6	 Carriage bolt M8x60	4	8
7	 M8x40 BOLT (SS)	4	6
8	 Carriage bolt M10x50	1	1
9	 HTCOR6 75x40X8	1	1
10	 M10 Flange nut	1	1
11	 M8 Flange nut	10	18
12	 M8 Locking nut (SS)	8	6
13	 HTCOR2	4	6
14	 M8 Washer	28	32
15	 M8 Wide washer (SS)	16	28
16	 M8 Spring washer	10	16
17	 M8x35 Bolt (SS)	4	8

Mid wheel base (L2 / L3 (WB3520) ORION 38KIT

1. Start mounting at the front left side. Mount front left bracket. (2)
When mounting the brackets do not fully tighten them (80%)
2. Mount the rear left bracket. (2)
3. Mount the rear right bracket (3). Make sure both rear brackets are in-line for mounting of the crossbar (1).
4. Mount crossbar (1)
5. Mount the front right bracket (3).
6. Install the sidebars (left / right) onto the brackets.
Attention! Sidebar lip needs to be positioned on top of the bracket.
7. Fully tighten all bolts.
8. Now start mounting the front support brackets. (4) These make the construction stronger. Start at the front left. First you need to make some room by untightening the plastic side protection. (Fig.5 / Fig.6) 2 screws will be enough to make room. When there is enough room for installing a bolt from the outer to the inner side, drill a hole install the bolt and mount the bracket (Fig.9 / Fig.10) Do not forget to tighten the plastic cover screws.
9. Go to the right front and mount the right support bracket (4) (Fig.7 / Fig.8)
There is no need to loosen the plastic protection covers at the right side.

Long wheel base L4 / L5 (WB4100) ORION 39KIT

1. Start mounting at the front left side. Mount front left bracket. (2)
When mounting the brackets do not fully tighten them (80%)
2. Mount the rear left bracket. (2)
3. Mount the rear right bracket (3). Make sure both rear brackets are in-line for mounting of the crossbar (1).
4. Mount crossbar (1)
5. Mount the front right bracket (3).
6. Install the sidebars (left / right) onto the brackets.
Attention! Sidebar lip needs to be positioned on top of the bracket.
7. Look for a position to mount the middle brackets (2 and 3) Try to find a position that both brackets can be mounted in-line, like the rear brackets and will fit the sidebar. If the brackets are in-line mount the crossbar (4). **The chassis varies so it is not always possible to align both brackets.** If not possible mount the brackets in a way they will fit the sidebars and continue.
8. Fully tighten all bolts.
9. Now start mounting the front support brackets. (4) These make the construction stronger. Start at the front left. First you need to make some room by untightening the plastic side protection. (Fig.5 / Fig.6) 2 screws will be enough to make room. When there is enough room for installing a bolt from the outer to the inner side, drill a hole, install the bolt and mount the bracket (Fig.9 / Fig.10). Do not forget to tighten the plastic cover screws.
10. In case you could mount the crossbar (1) in the middle go to the front right and mount the support bracket. (Fig.7 / Fig.8) and you are finished. **There is no need to loosen the plastic protection covers here.** If you could not mount the crossbar continue to step 11.
11. Mount the other 3 support brackets (4) and you are finished. **There is no need to loosen the plastic protection covers for these 3 brackets.**

! Use PART NUMBER 9 for mounting the RIGHT FRONT BRACKET.
Use the ZINC hardware for mounting the brackets 2, 3 and cross bar 1.
Use the STAINLESS STEEL hardware for mounting bracket 4 and the SIDE BARS.

